

Large Metal Tool Cabinet



The following is an introduction to large metal tool cabinet, CYJY hope to help you better understand large metal tool cabinet. Welcome new and old customers to continue to cooperate with us to create a better future together! Large metal tool cabinet with wheels and locks for easy move and safe. The surface finished is powder coated is good for waterproof and anti-corrosion in any hostile environment.

Large Metal Tool Cabinet

Welcome to wholesale or customized **large metal tool cabinet** from our factory at any time. We will provide you with factory discount prices for our products. CYJY is **large metal tool cabinet** manufacturers and suppliers in China.

Chengyuan Jiayu is a Chinese factory specializing in the manufacture of **large metal tool cabinets**. The overall frame of the **large metal tool cabinet** is made of cold-rolled steel plate material, which is strong and stable. The drawer is made of galvanized steel material, which is anti-corrosion and anti-rust. The handle is made of aluminum alloy, which is corrosion-resistant and high-temperature resistant, and has high performance. There are 27 drawers on the cabinet and 15 drawers beside the cabinet, which can be used to classify and store tools or parts. Liners can be customized inside each drawer to prevent tools or parts from sliding and being damaged. The color, style and size of the entire cabinet can be customized according to your needs. Your consultation and order are welcome.

- 1.material:cold rolling steel
- 2.Finished: powder coated
- 3.Handle:Alunimun
- 4.key lock
- 5.caster:6pcs 5 inch Pu caster
- 6.40ft container:18 sets



Large Metal Tool Cabinet Specifications

Steel thickness	18gauge/1.2mm
Lock	KEY lock
Color	BLACK/BLUE/RED/GRAY/ORANGE
Handle	Aluminum
Material:	Cold rolled steel
Caster	5 inch PU
Remark	OEM&ODM are available
Function	Storage for tools, files, home or office supplies

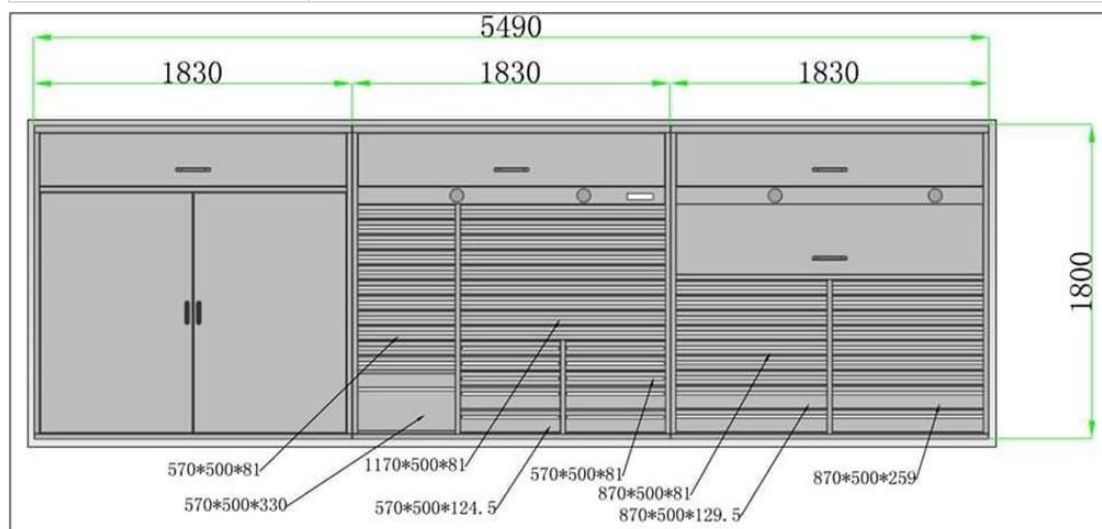

Large Metal Tool Cabinet Features

- ▶ Large capacity: The **Large Metal Tool Cabinet** is quite spacious and can store a lot of tools and equipment.
- ▶ High strength: Since it is a heavy duty tool cabinet, it has enough strength and durability to withstand heavy objects and different usage situations.
- ▶ Multifunctional: The 84-inch tool cabinet also has multiple drawers, cabinets or storage boxes, which can store different types of tools and spare parts.
- ▶ Easy to use: Each drawer has a slide rail, which is convenient to open and close the tool cabinet.
- ▶ High safety: The tool cabinet has a safety lock to protect the safety of tools and equipment.
- ▶ Free movement: the lower part of the cabinet has heavy-duty locking casters, which can be moved anytime and anywhere without restriction.



Instructions for use of Large Metal Tool Cabinet:

- ▶ Installation: The entire tool cabinet is received, and only the casters need to be installed.
- ▶ Storage tools: Store tools according to type, size, purpose, etc., divide them into different drawers or cabinets, and mark each storage area for later access.
- ▶ Maintain the tool cabinet: Regularly clean the inside and outside of the tool cabinet to ensure that the slide rails of the drawers and doors are unobstructed and unblocked, and maintain the glossiness of the cabinet surface.
- ▶ Use protection: When using tools, please pay attention to: use appropriate tools to complete certain tasks, do not use tools that are too large or unsuitable; when using Qingdao Chrecary International Trade Co., Ltd.

some insulated tools, please pay attention to safety; carefully store and put away tools, So as not to damage the drawers and cabinets.

▣ Precautions for use: Please use it according to the load-bearing standard of the tool cabinet, and avoid placing heavy or unstable items on the tool cabinet to avoid deformation or rupture of the cabinet; do not stand or sit on the tool cabinet to avoid falling or falling. The cabinet is deformed.

PRODUCTION PROCESS

Professional production, quality assurance

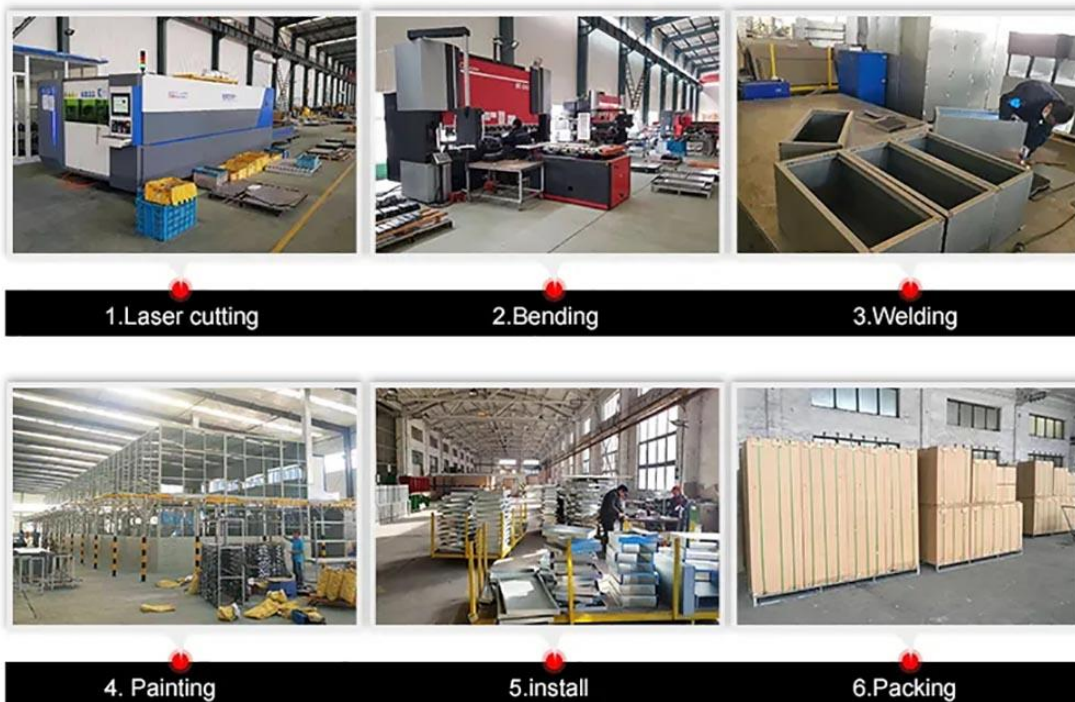

FAQ

Q: What are the characteristics of the product?

A: Our main products are various tool cabinet, tool trolley, tool box, garage use combination tool cabinet, electric tools and accessories, especially for people who like repair by themselves.

Q: What is your product positioning?

A: Our products are mainly for high-end consumers. Our price falls into average level among similar products. In the future, we will try to develop products for the low-income groups.

Q: What's your target market?

A: We mainly focus on European market right now. Our next step is to launch new products and expand our market to North America, South America and the Middle East. Qingdao Chrecary International Trade Co., Ltd.

